

This Old House

23
LOVELY,
LOW-COST
GARDEN
IDEAS
p. 78

Make your home special!

Add a personal touch with *charming* built-ins, *pretty* painted floors, and *one-of-a-kind* wainscot

8 secrets to an updated farmhouse look p. 72

Colorful, carefree new plants for pots

 PARTY HOT SPOT!
BACKYARD COCKTAIL CABINET

Clever ways to bust clutter at the door

MAY 2013
THISOLDHOUSE.COM



before + after: bath

Current look, classic feel

A master bedroom addition makes room for a graceful bath that fuses old and new

By MEGAN BAKER + Photographs by PATRICIA LYONS

Incorporating contemporary sensibilities into a period home can be tricky. Patricia Jagtiani loved the vintage charm of her 1930s house, in Alexandria, Virginia, but when she decided to add a master bath—part of a renovation that included a new master bedroom addition—she hoped for something more modern. Taking the place of the former master bedroom, the bath features a blended style inspired by an early find: the clean-lined sink, an update of the classic console. Patricia chose a tub to match, settling on a rectangular jetted soaker juxtaposed with Victorian-style fittings. A bright and airy shower enclosure sits adjacent to it. On the walls, she added vintage-inspired blue and white tile, keeping it current in a blown-out size. Marble tile underfoot and period-perfect molding throughout ensure the room fits with the rest of the home.

The fusion is just what Patricia was looking for. “It was created for me, with everything I like,” she says. “It’s a peaceful haven I lacked before.”

before The master bedroom occupied this space. **after** The new bath's contemporary look is tempered by period details. Sink and toilet: Duravit. Faucet: Brizo. Sconces and mirror: Restoration Hardware. Basket: West Elm



← Cylinder sconces and an oval mirror soften the lines of the angular console sink.



{ before }

before+after: **bath**

→ **The modern, boxy tub** has a broad deck for toiletries and a separate handshower to accompany the wall-mount shepherd's crook faucet. Towels hang within reach from a vintage-style train rack. *Tub: Aquatic Bath. Train rack: Restoration Hardware. Faucet: Riobel. Handshower: Brizo*

↓ **Subway tile** gets a shake-up with fresh 5-by-10-inch dimensions and diamond insets. A classic tile chair rail with bullnose corners caps it off. *Wall tile: Ceramiche Grazia*



before

The 121-square-foot space held the master bedroom.

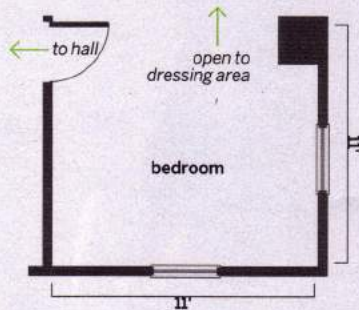

after

Gutted, plumbed, and rebuilt, the room became a bath with a 6-foot tub and a separate shower enclosure.

1_ Built in the tub right at the room's entry to maximize an open feel in the room.

2_ Chose a shower enclosure with frameless glass doors to channel light from the window.

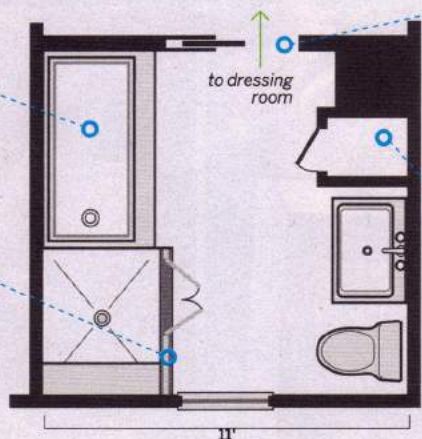

3_ Created an entry with a space-saving pocket door to the dressing room, which connects the bath to the hallway and new master bedroom.

4_ Installed a linen closet that blends with an exposed chimney chase. This former exterior wall became an interior wall, with the addition beyond it.